

CULTURAL LANDSCAPE CONSERVATION REFERENCES

Website

Olmsted Center for Landscape Preservation

National Park Service

U.S. Department of the Interior

www.nps.gov/oclp/links.htm

Comprehensive listings for NPS websites and publications, links to other conservation organizations, and download for A Guide to Cultural Landscape Reports, Landscape Lines and Clippings

The Cultural Landscape Foundation (TCLF)

<http://tclf.org/landscapes/what-are-cultural-landscapes>

Non-profit foundation dedicated to providing people with the ability to see, understand and value landscape architecture and its practitioners, in the way many people have learned to do with buildings and their designers.

Publications

Preservation Brief 36: Protecting Cultural Landscapes: Planning, Treatment and Management of Historic Landscapes, by Charles Birnbaum

The Secretary of the Interior's Standards for the Treatment of Historic Properties with Guidelines for the Treatment of Cultural Landscapes

Guide to Developing a Preservation Maintenance Plan for a Historic Landscape, by Margaret Coffin and Regina Bellavia

A Guide to Cultural Landscape Reports: Contents, Process, and Techniques, by Robert R. Page, Cathy A. Gilbert and Susan Dolan

Available from Olmsted website or at:

www.nps.gov/cultural_landscapes/Documents/Guide_to_Cultural_Landscapes.pdf

**GETTING TO KNOW
CULTURAL LANDSCAPES**

Landscapes: Looking Beyond Buildings
Holly Kane CPF March 2014

What is a Cultural Landscape?

A cultural landscape is fashioned from a natural landscape by a culture group. Culture is the agent, the natural area is the medium. The cultural landscape the result.

Carl Sauer

Carl O. Sauer, *The Morphology of Landscape*, 1925.

Landscape is *never* simply a natural space, a feature of the natural environment. [E]very landscape is the place where we establish our own human organization of space and time.

John Brinkerhoff Jackson

John B. Jackson, *Discovering the Vernacular Landscape*, 1984

Cultural landscapes represent the "combined works of nature and of man" designated in Article 1 of the Convention. They are illustrative of the evolution of human society and settlement over time, under the influence of the physical constraints and/or opportunities presented by their natural environment and of successive social, economic and cultural forces, both external and internal.

World Heritage Convention, 1992

Cultural Landscapes
Provide a sense of place and identity; they map our relationship with the land over time; and they are part of our national heritage and each of our lives.

The Cultural Landscape Foundation (TCLF)

Cultural Landscape Reports (CLRs)



Landscape implies far more than high-style aesthetics; it is a document of the shared aspirations, ingenuity, memories, and culture of its builders.
-- J.B. Jackson

A CLR clearly identifies the **landscape characteristics** and associated features, values and associations that **make a landscape historically significant**.

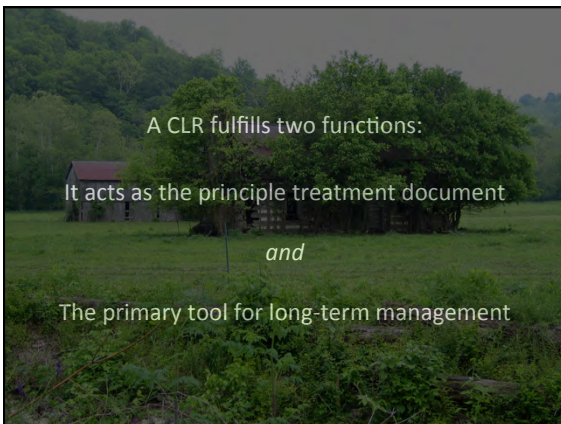

A CLR fulfills two functions:
It acts as the principle treatment document
and
The primary tool for long-term management

Four Types of Cultural Landscapes

- 1) Historic Sites
- 2) Historic Designed Landscapes
- 3) Historic Vernacular Landscapes
- 4) Ethnographic Landscapes



1) Historic Site
a landscape significant for its association with a historic event, activity or person

Historic site – Ralph J. Bunche House



Boyhood home of
Nobel Prize winner
Ralph J. Bunche

National Register,
Los Angeles Historic
Cultural Monument #159

1221 E. 40th Place
South Los Angeles
Constructed ca. 1915

Historic Site – Adams National Historic Site







Photo Courtesy of Adams National Historic Site

2) Historic Designed Landscape
a landscape significant as a design or work of art



Historic Designed Landscape – Baldwin Hills Village (aka Village Green)



National Historic Landmark



Landscape Architect
Fred Barlow, Jr
1941

Historic Designed Landscape –
Central Park



Greensward Plan, Olmsted & Vaux, 1857

Historic Designed Landscape –
Exposition Park Rose Garden



3) Historic Vernacular Landscape
a landscape whose physical, biological,
and cultural features reflect the
customs and everyday lives of people.







Ethnographic Landscape – Devil's Tower



National Monument, declared 1906 Wyoming Photo: 2b.bp.blogspot.com

Ethnographic Landscapes



Gullah culture on the Sea Islands
Painting – *Fetching Collards* by John W. Jones

Evaluating Landscapes

Significance

The importance of a property to the history, architecture, archeology, engineering, or culture of a community, a state, or the nation.



Gamble House, Pasadena
1908

Period of Significance

The span of time during which significant events and activities occurred.



Taos Pueblo drawing

Case Study

Baldwin Hills Village (The Village Green)

- National Historic Landmark
- Period of Significance 1935-1942
- Multi-family residential property
- 68 acres
- 5300 Rodeo Road, Los Angeles

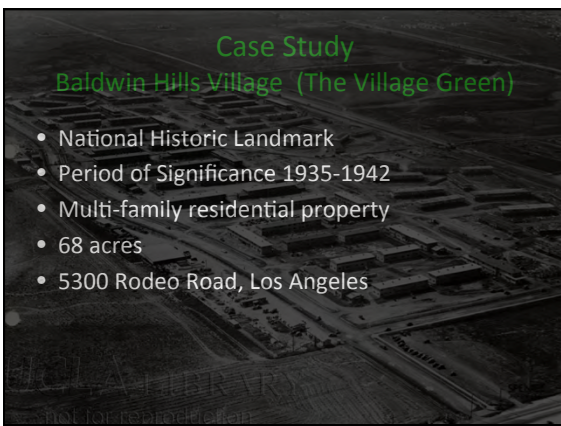

Case Study –
Baldwin Hills
Village NHL

NATIONAL HISTORIC LANDMARK NOMINATION
BALDWIN HILLS VILLAGE

I. NAME OF PROPERTY
Historic Name: Baldwin Hills Village
Other Name(s) (if known): Village Green

II. LOCATION
Address & Section: 2300-2330 Wilshire Blvd. City: Los Angeles, CA
County: Los Angeles
State: California Census Locality: Census Code: 022 Fire Code: 0802

III. CLASSIFICATION

Category of Property:	Category of Property:
Private <input checked="" type="checkbox"/>	Building(s) <input checked="" type="checkbox"/>
Public Land <input type="checkbox"/>	Other <input type="checkbox"/>
Public Domain <input type="checkbox"/>	Site <input type="checkbox"/>
Public Building <input type="checkbox"/>	Structure <input type="checkbox"/>
	Object <input type="checkbox"/>

Number of Resources within Property:
 Groupings: 1
 Buildings: 25
 Sites: 2
 Structures: 28
 Objects: 4
 Other: 26
 Total: 94

Number of Contributing Resources Previously Listed in the National Register of Historic Places: 0

Case Study –
Baldwin Hills
Village NHL

NATIONAL HISTORIC LANDMARK NOMINATION
BALDWIN HILLS VILLAGE

Describing official use considered the significance of the property in relation to other properties:
 National: X International: _____

Applicable National Program Criteria: A, B, C, D, E, F, G, H, I, J, K, L, M, N, O, P, Q, R, S, T, U, V, W, X, Y, Z, AA, AB, AC, AD, AE, AF, AG, AH, AI, AJ, AK, AL, AM, AN, AO, AP, AQ, AR, AS, AT, AU, AV, AW, AX, AY, AZ, BA, BB, BC, BD, BE, BF, BG, BH, BI, BJ, BK, BL, BM, BN, BO, BP, BQ, BR, BS, BT, BU, BV, BW, BX, BY, BZ, CA, CB, CC, CD, CE, CF, CG, CH, CI, CJ, CK, CL, CM, CN, CO, CP, CQ, CR, CS, CT, CU, CV, CW, CX, CY, CZ, DA, DB, DC, DD, DE, DF, DG, DH, DI, DJ, DK, DL, DM, DN, DO, DP, DQ, DR, DS, DT, DU, DV, DW, DX, DY, DZ, EA, EB, EC, ED, EE, EF, EG, EH, EI, EJ, EK, EL, EM, EN, EO, EP, EQ, ER, ES, ET, EU, EV, EW, EX, EY, EZ, FA, FB, FC, FD, FE, FF, FG, FH, FI, FJ, FK, FL, FM, FN, FO, FP, FQ, FR, FS, FT, FU, FV, FW, FX, FY, FZ, GA, GB, GC, GD, GE, GF, GG, GH, GI, GJ, GK, GL, GM, GN, GO, GP, GQ, GR, GS, GT, GU, GV, GW, GX, GY, GZ, HA, HB, HC, HD, HE, HF, HG, HH, HI, HJ, HK, HL, HM, HN, HO, HP, HQ, HR, HS, HT, HU, HV, HW, HX, HY, HZ, IA, IB, IC, ID, IE, IF, IG, IH, II, IJ, IK, IL, IM, IN, IO, IP, IQ, IR, IS, IT, IU, IV, IW, IX, IY, IZ, JA, JB, JC, JD, JE, JF, JG, JH, JI, JJ, JK, JL, JM, JN, JO, JP, JQ, JR, JS, JT, JU, JV, JW, JX, JY, JZ, KA, KB, KC, KD, KE, KF, KG, KH, KI, KJ, KK, KL, KM, KN, KO, KP, KQ, KR, KS, KT, KU, KV, KW, KX, KY, KZ, LA, LB, LC, LD, LE, LF, LG, LH, LI, LJ, LK, LL, LM, LN, LO, LP, LQ, LR, LS, LT, LU, LV, LW, LX, LY, LZ, MA, MB, MC, MD, ME, MF, MG, MH, MI, MJ, MK, ML, MM, MN, MO, MP, MQ, MR, MS, MT, MU, MV, MW, MX, MY, MZ, NA, NB, NC, ND, NE, NF, NG, NH, NI, NJ, NK, NL, NM, NN, NO, NP, NQ, NR, NS, NT, NU, NV, NW, NX, NY, NZ, OA, OB, OC, OD, OE, OF, OG, OH, OI, OJ, OK, OL, OM, ON, OO, OP, OQ, OR, OS, OT, OU, OV, OW, OX, OY, OZ, PA, PB, PC, PD, PE, PF, PG, PH, PI, PJ, PK, PL, PM, PN, PO, PP, PQ, PR, PS, PT, PU, PV, PW, PX, PY, PZ, QA, QB, QC, QD, QE, QF, QG, QH, QI, QJ, QK, QL, QM, QN, QO, QP, QQ, QR, QS, QT, QU, QV, QW, QX, QY, QZ, RA, RB, RC, RD, RE, RF, RG, RH, RI, RJ, RK, RL, RM, RN, RO, RP, RQ, RR, RS, RT, RU, RV, RW, RX, RY, RZ, SA, SB, SC, SD, SE, SF, SG, SH, SI, SJ, SK, SL, SM, SN, SO, SP, SQ, SR, SS, ST, SU, SV, SW, SX, SY, SZ, TA, TB, TC, TD, TE, TF, TG, TH, TI, TJ, TK, TL, TM, TN, TO, TP, TQ, TR, TS, TT, TU, TV, TW, TX, TY, TZ, UA, UB, UC, UD, UE, UF, UG, UH, UI, UJ, UK, UL, UM, UN, UO, UP, UQ, UR, US, UT, UY, UZ, VA, VB, VC, VD, VE, VF, VG, VH, VI, VJ, VK, VL, VM, VN, VO, VP, VQ, VR, VS, VT, VU, VW, VX, VY, VZ, WA, WB, WC, WD, WE, WF, WG, WH, WI, WJ, WK, WL, WM, WN, WO, WP, WQ, WR, WS, WT, WU, WV, WX, WY, WZ, XA, XB, XC, XD, XE, XF, XG, XH, XI, XJ, XK, XL, XM, XN, XO, XP, XQ, XR, XS, XT, XU, XV, XW, XX, XY, XZ, YA, YB, YC, YD, YE, YF, YG, YH, YI, YJ, YK, YL, YM, YN, YO, YP, YQ, YR, YS, YT, YU, YV, YW, YX, YY, YZ, ZA, ZB, ZC, ZD, ZE, ZF, ZG, ZH, ZI, ZJ, ZK, ZL, ZM, ZN, ZO, ZP, ZQ, ZR, ZS, ZT, ZU, ZV, ZW, ZX, ZY, ZZ

Number of Resources within Property:
 Groupings: 1
 Buildings: 25
 Sites: 2
 Structures: 28
 Objects: 4
 Other: 26
 Total: 94

Number of Contributing Resources Previously Listed in the National Register of Historic Places: 0

Use of Landscape Characteristics
in
Cultural Landscape Reports



Landscape Characteristics

- Spatial Organization
- Land Use
- Cultural Traditions
- Cluster Arrangement
- Circulation
- Vegetation
- Buildings and Structures
- Views and Vistas
- Constructed Water Features
- Small-scale Features

Use of Landscape Characteristics in Cultural Landscape Reports

- 1) gathering, organizing, and understanding information about the site history and existing conditions of a cultural landscape,
- 2) documenting the changing appearance of a landscape over time.



Land Use



The principle activities in a landscape that form, shape and organize the landscape as a result of human interaction.

Cultural Traditions

Practices that influence the development of a landscape in terms of land use, patterns of land division, building forms, stylistic preferences, and the use of materials.



Cluster Arrangement



Location and pattern of buildings and structures in a landscape and associated outdoor spaces.

Circulation



The spaces, features, and applied material finishes that constitute the systems of movement in a landscape.

Vegetation



Includes the deciduous and evergreen trees, shrubs, vines, ground covers and herbaceous plants, and plant communities, whether indigenous or introduced in a landscape.



Buildings and Structures



Views and Vistas

Views are the expansive or panoramic prospect of a broad range of vision, which may be naturally occurring or deliberately contrived.



Vistas are the controlled prospect of a discrete, linear range of vision, which is deliberately contrived.



Constructed Water Features



The built features and elements that use water for aesthetic or utilitarian functions in a landscape.

Small-Scale Features



The elements providing detail and diversity for both functional needs and aesthetic concerns in a landscape.

Cultural Landscape Reports



Guiding
Future
Landscape
Decisions

RESOURCES:

- Olmsted Center
- TCLF (The Cultural Landscape Foundation)
- NPS Brief #36



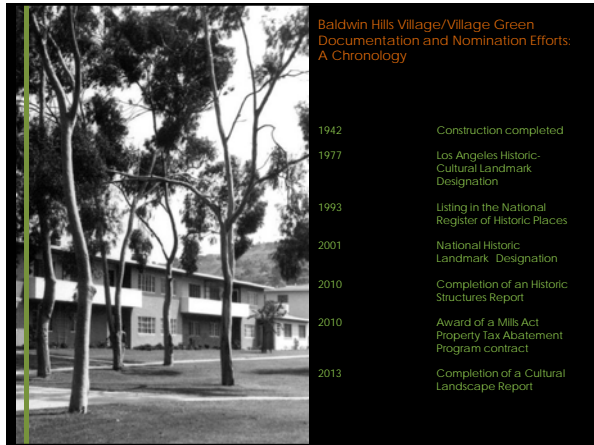

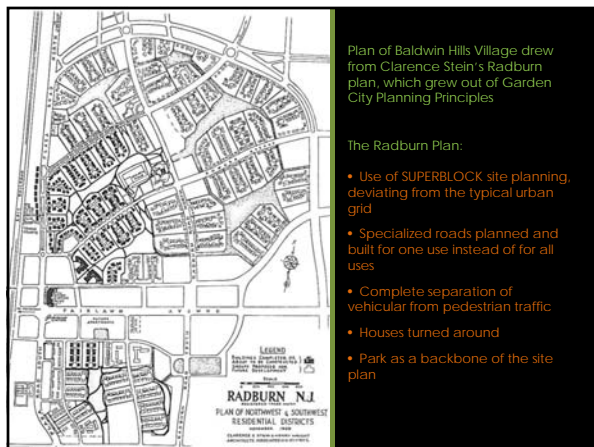





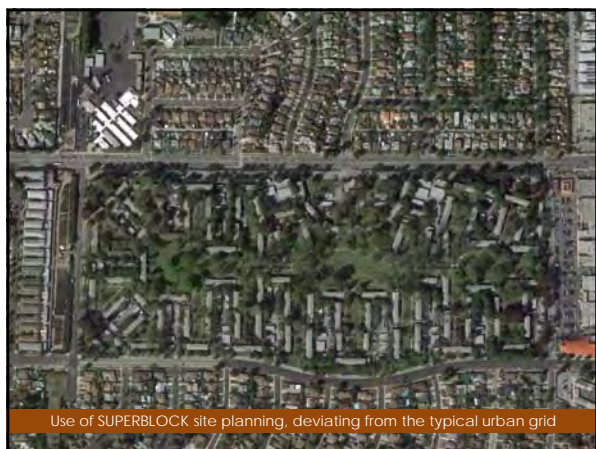

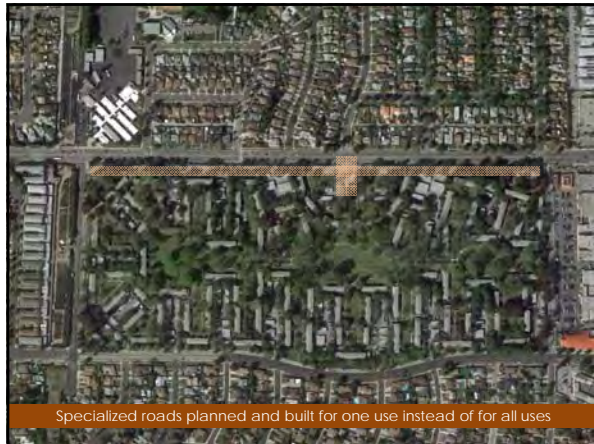







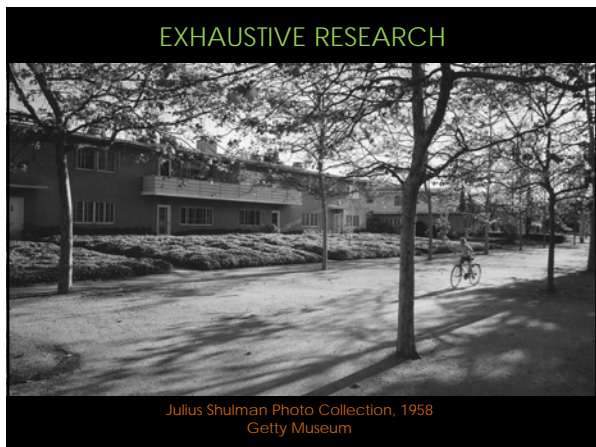



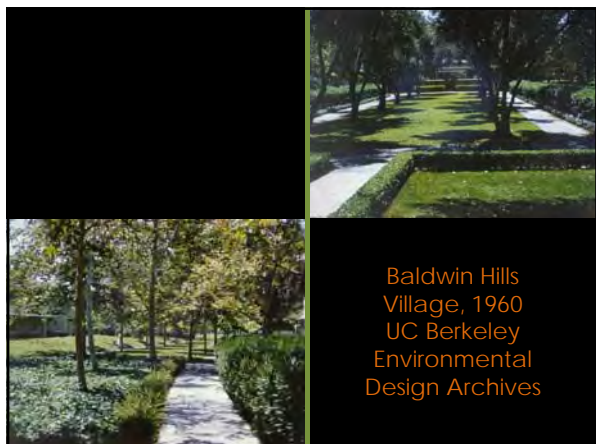













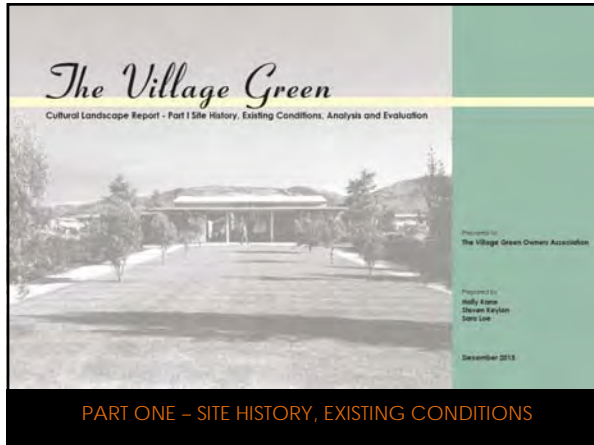

PART ONE – SITE HISTORY, EXISTING CONDITIONS

A page titled 'Table of Contents' with a list of sections and their corresponding page numbers. The sections include Introduction, Site History, Existing Conditions, Analysis and Evaluation, and Appendices.

PART ONE CONTENTS

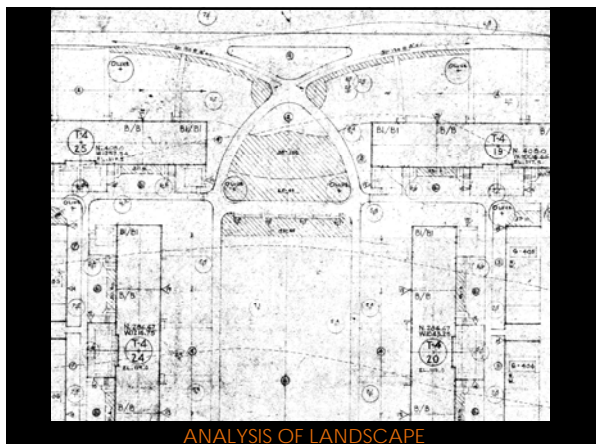



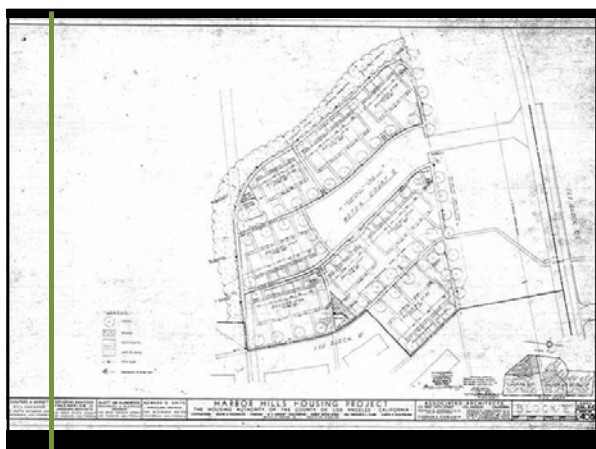



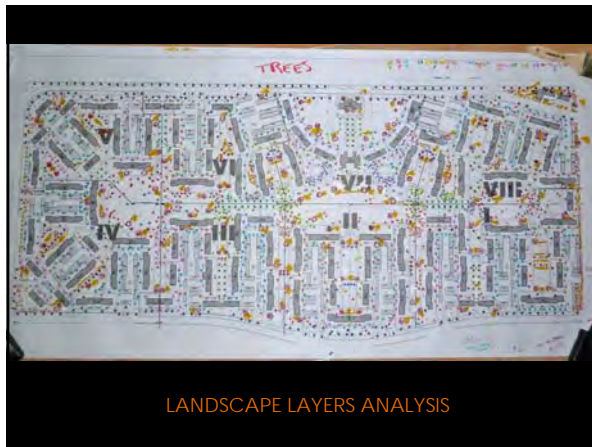



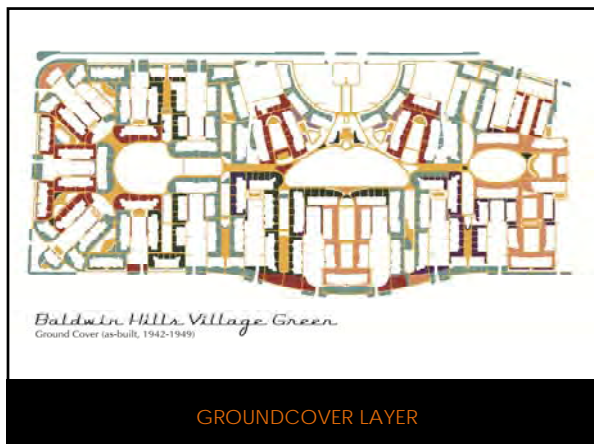

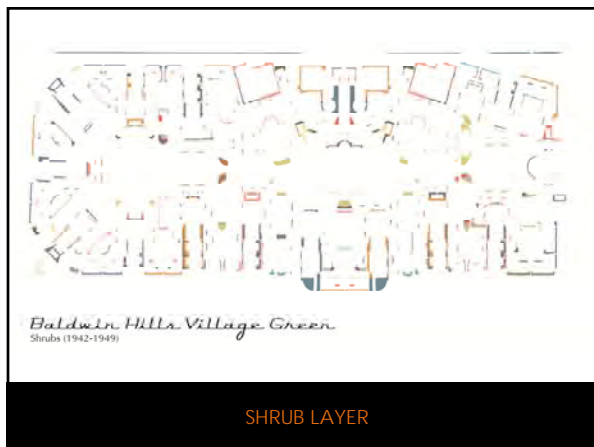



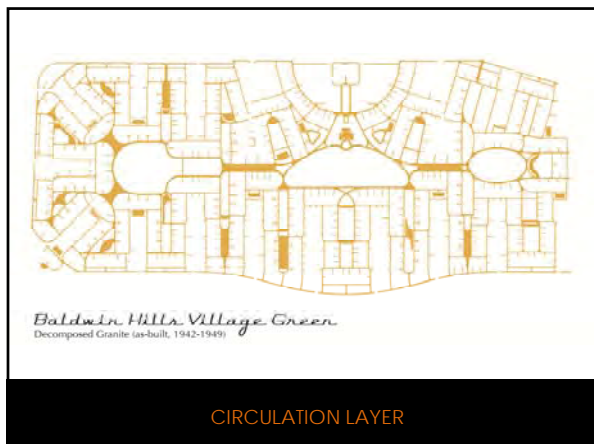

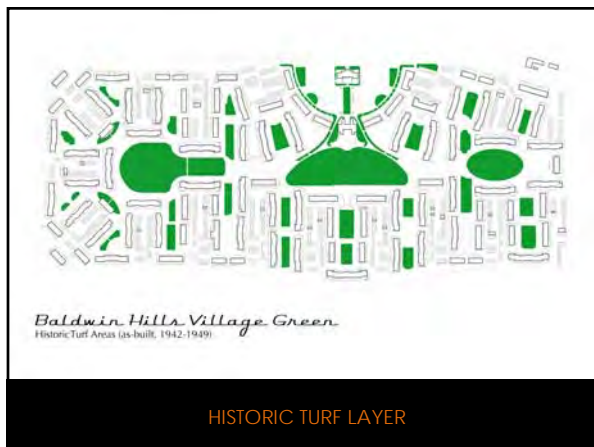







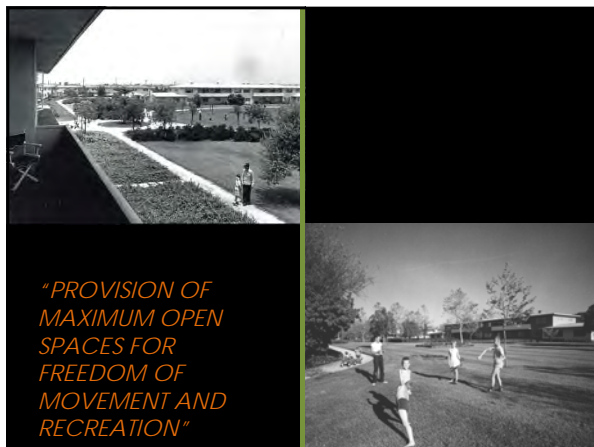





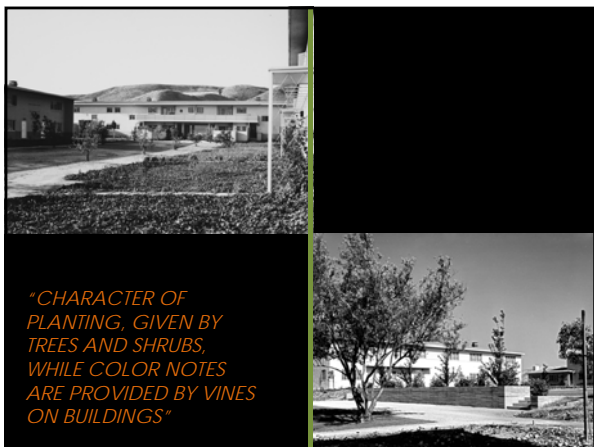

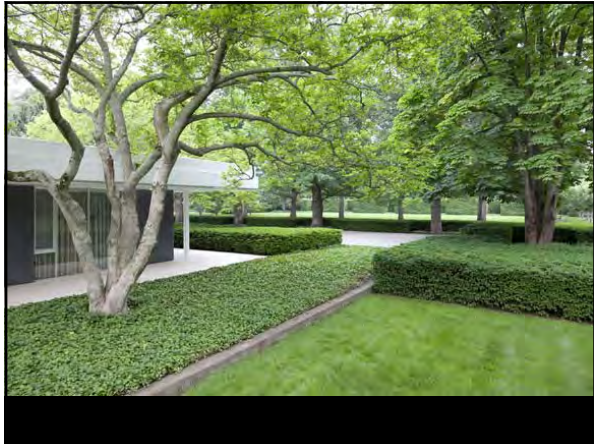







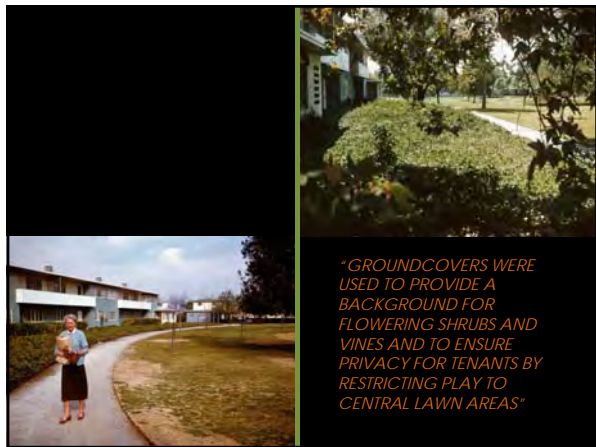



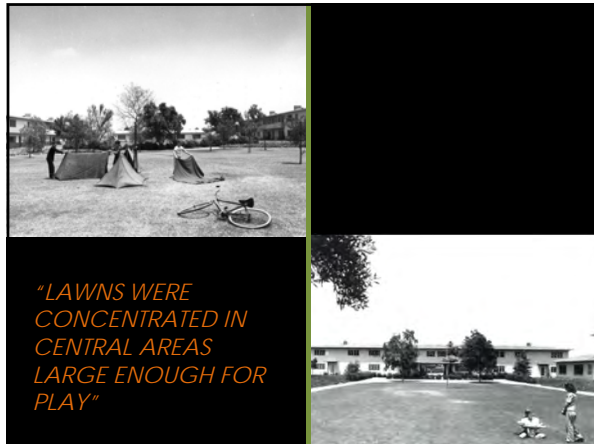

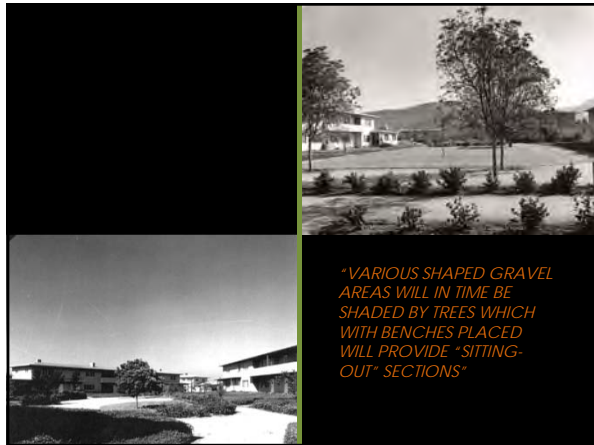



















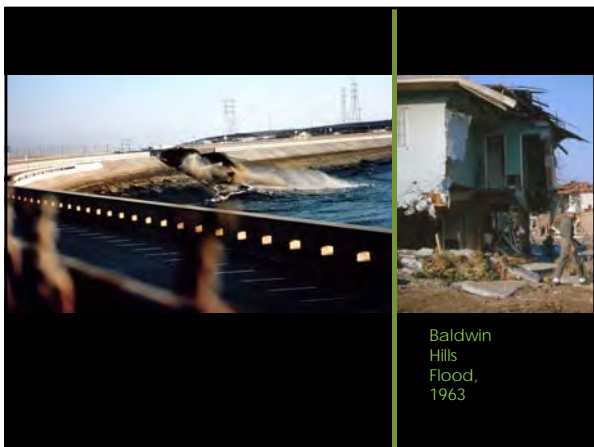















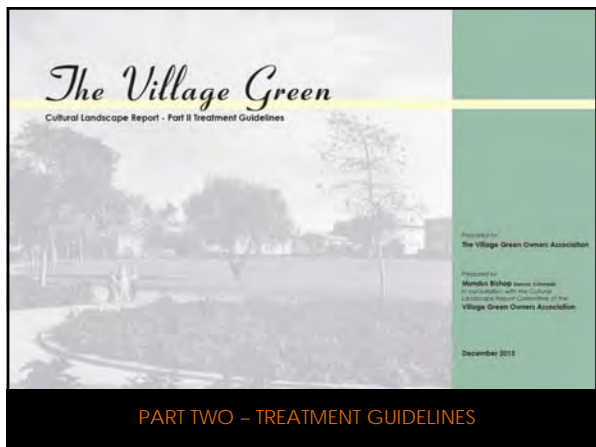







CONCEPT VISION

THE VILLAGE GREEN Cultural Landscape Report - Part A

GUIDING PRINCIPLES

The historic preservation of the Village Green is a complex task that requires a balance of historic preservation, landscape architecture, and community development. The following guiding principles are intended to guide the design and implementation of the Village Green Cultural Landscape Report.

1. Identify the historic and architectural resources of the Village Green and determine their significance and value.
2. Assess the current condition of the Village Green and identify areas of concern and opportunity.
3. Develop a vision for the Village Green that is consistent with its historic character and the needs of the community.
4. Create a plan for the Village Green that includes specific recommendations for design, construction, and management.
5. Implement the plan for the Village Green in a way that is sensitive to the needs of the community and the environment.

CONCEPT VISION

The vision of the Village Green is to create a vibrant, historic, and sustainable community space that is accessible to all. The vision is based on the following principles:

- Preserve the historic character of the Village Green.
- Enhance the landscape architecture of the Village Green.
- Create a vibrant and sustainable community space.
- Ensure that the Village Green is accessible to all.
- Implement the vision in a way that is sensitive to the needs of the community and the environment.

SECTION 3.0 Concept Vision

GUIDING PRINCIPLES/CONCEPT VISION

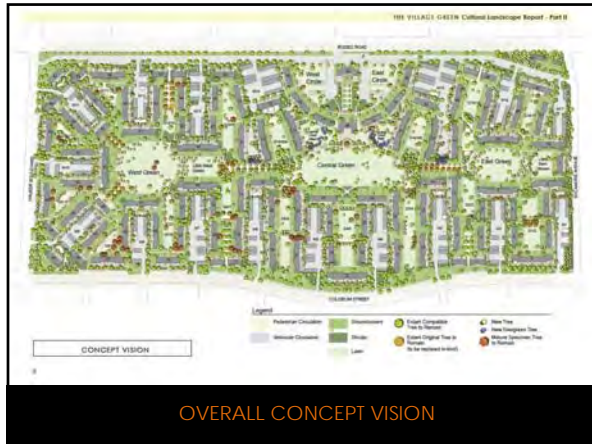

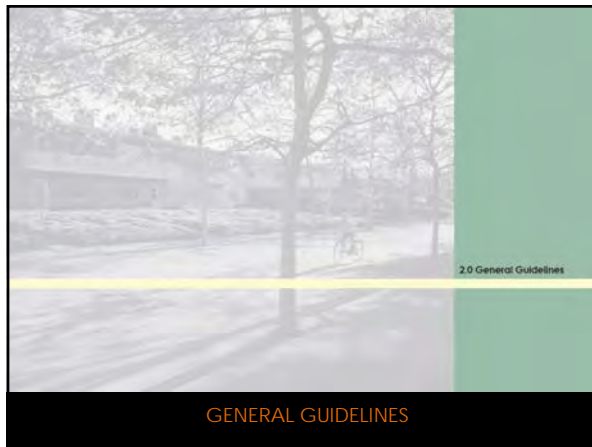

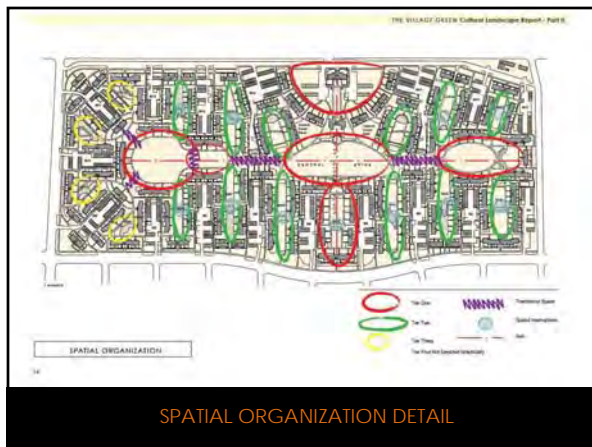



GARDEN COURTS TREATMENT PLAN

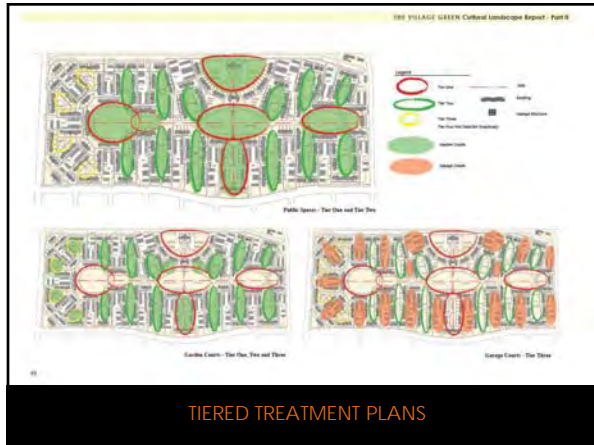

TIERED TREATMENT PLANS



CENTRAL SPINE TREATMENT PLAN





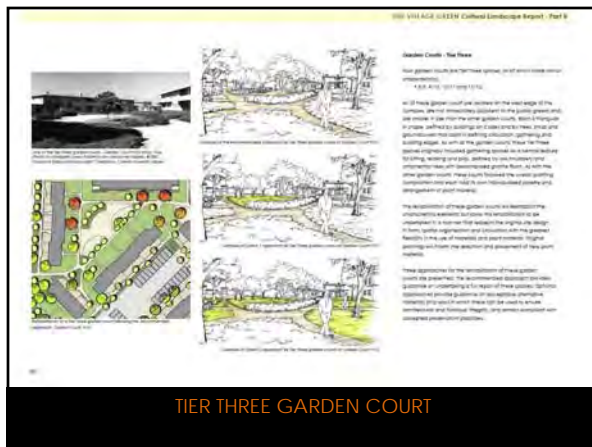

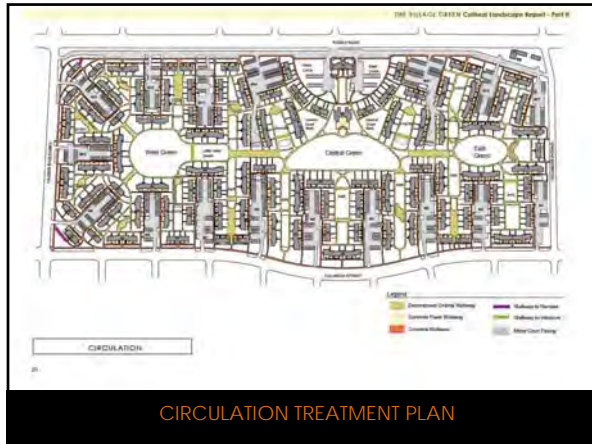





THE VILLAGE GREEN Cultural Landscape Report - Part A

SECTION 2.0 General Guidelines

Trees

The trees along the Village Green are the most significant historical landscape element and should be preserved, repaired and enhanced wherever possible. The trees that are in the Village Green should be preserved, repaired and enhanced wherever possible. The trees that are in the Village Green should be preserved, repaired and enhanced wherever possible.

The trees should be preserved, repaired and enhanced wherever possible. The trees should be preserved, repaired and enhanced wherever possible. The trees should be preserved, repaired and enhanced wherever possible.

The trees should be preserved, repaired and enhanced wherever possible. The trees should be preserved, repaired and enhanced wherever possible. The trees should be preserved, repaired and enhanced wherever possible.

The trees should be preserved, repaired and enhanced wherever possible. The trees should be preserved, repaired and enhanced wherever possible. The trees should be preserved, repaired and enhanced wherever possible.

The trees should be preserved, repaired and enhanced wherever possible. The trees should be preserved, repaired and enhanced wherever possible. The trees should be preserved, repaired and enhanced wherever possible.

The trees should be preserved, repaired and enhanced wherever possible. The trees should be preserved, repaired and enhanced wherever possible. The trees should be preserved, repaired and enhanced wherever possible.

The trees should be preserved, repaired and enhanced wherever possible. The trees should be preserved, repaired and enhanced wherever possible. The trees should be preserved, repaired and enhanced wherever possible.



TREES TREATMENT PLAN DETAIL

THE VILLAGE GREEN Cultural Landscape Report - Part A



SHRUBS, GROUNDCOVERS, LAWN



APPENDICES

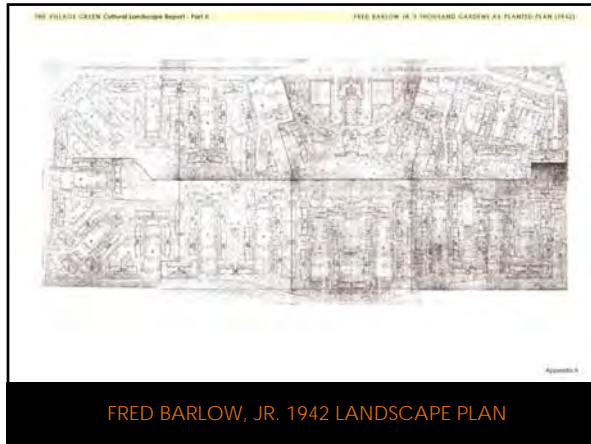

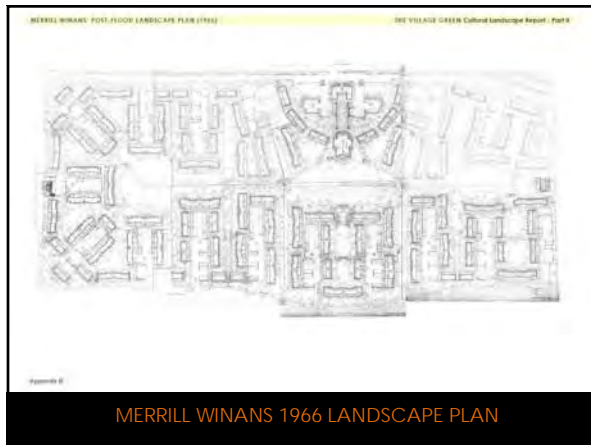

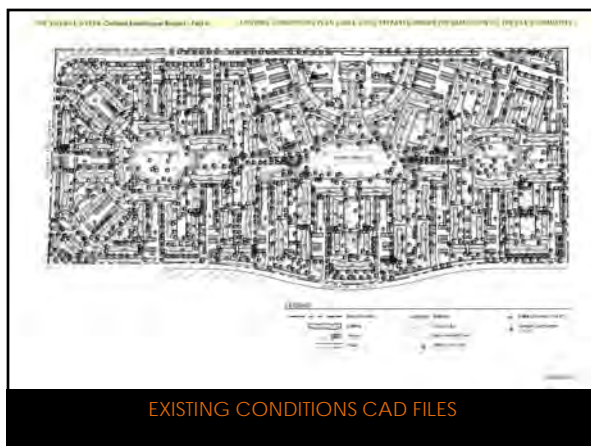

HISTORIC RESOURCES TECHNICAL REPORT

HALLIBURTON HOUSE INDIRECT IMPACTS ASSESSMENT

Historic Resources Survey and Analysis of Potential Indirect Development Impacts



March 2013

HALLIBURTON HOUSE
31172 Ceanothus Drive, Laguna Beach

Prepared for:

City of Laguna Beach
Department of Community Development
505 Forest Avenue, Laguna Beach, CA 92651

Prepared by:

Jan Ostashay Principal
Ostashay & Associates Consulting
PO BOX 542, Long Beach, CA 90801

HALLIBURTON HOUSE INDIRECT IMPACTS ASSESSMENT

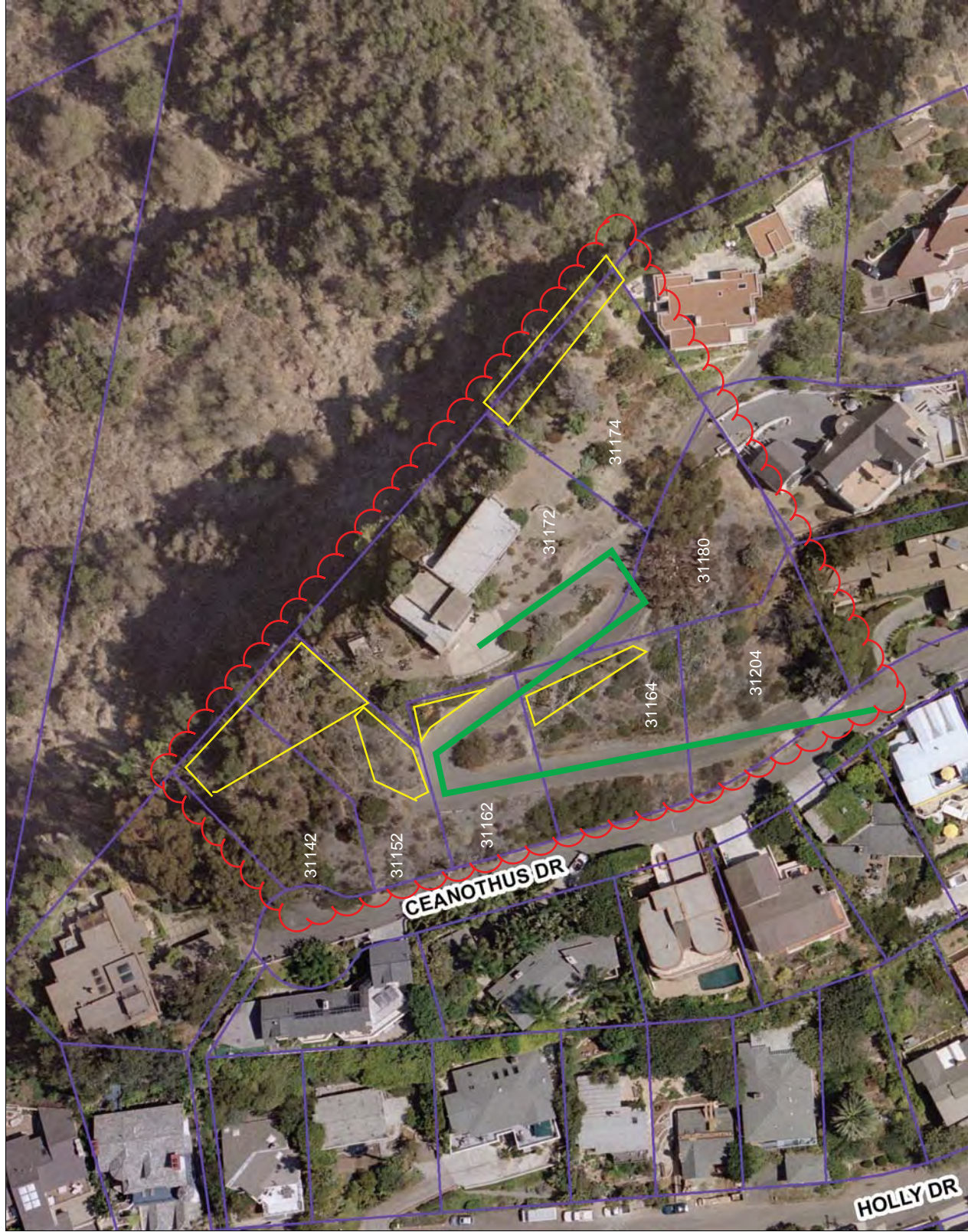

- Legend**
- City Limits
 - Parcels
 - 2008 Color Aerial Orthophotos
 - Red: Band_1
 - Green: Band_2
 - Blue: Band_3
 - 2008 Building Footprints

- Topographic Characteristics**
- Circulation Features
 - Vegetation & Outcropping Features

1:1,023

Notes

FIGURE 3-3
ADJACENT VACANT BUILDING SITES:
SITE-SPECIFIC
CHARACTER-DEFINING FEATURES

Data layers that appear on this map may or may not be accurate, current, or otherwise reliable.

171 Feet

85

0

171





Ceanothus Drive Streetscape, 31204, 31164, 31162, 31152 Ceanothus Drive



Ceanothus Drive Streetscape, 31142, 31152, 31162, 31164 Ceanothus Drive

HALLIBURTON HOUSE INDIRECT IMPACTS ASSESSMENT

31172 Ceanothus Drive



Circulation Features and Topographic Characteristics, 31204 Ceanothus Drive



Circulation Features, 31204 Ceanothus Drive

HALLIBURTON HOUSE INDIRECT IMPACTS ASSESSMENT

31172 Ceanothus Drive

FIGURE 3-5

VERNACULAR CULTURAL LANDSCAPE PHOTO INVENTORY



Circulation Features (embankment wall and driveway detail), 31164 and 31204 Ceanothus Drive



Circulation Features, Topographic Characteristics, 31162, 31164, 31204 Ceanothus Drive

HALLIBURTON HOUSE INDIRECT IMPACTS ASSESSMENT
31172 Ceanothus Drive



Circulation Features, Topographic Characteristics, Vegetation Features, 31152, 31162, 31164 Ceanothus Drive



Circulation Features, Vegetation Features, 31162, 31164, 31180 Ceanothus Drive

HALLIBURTON HOUSE INDIRECT IMPACTS ASSESSMENT

31172 Ceanothus Drive

FIGURE 3-7

VERNACULAR CULTURAL LANDSCAPE PHOTO INVENTORY



Circulation Features, Topographic Characteristics, Vegetation Features, 31164, 31162 Ceanothus Drive



Circulation Features, Topographic Characteristics, Vegetation Features, Views and Setting, 31162, 31164 Ceanothus Drive

HALLIBURTON HOUSE INDIRECT IMPACTS ASSESSMENT

31172 Ceanothus Drive

FIGURE 3-8
VERNACULAR CULTURAL LANDSCAPE PHOTO INVENTORY



Topographic Characteristics, Vegetation Features, 31164, 31180 Ceanothus Drive

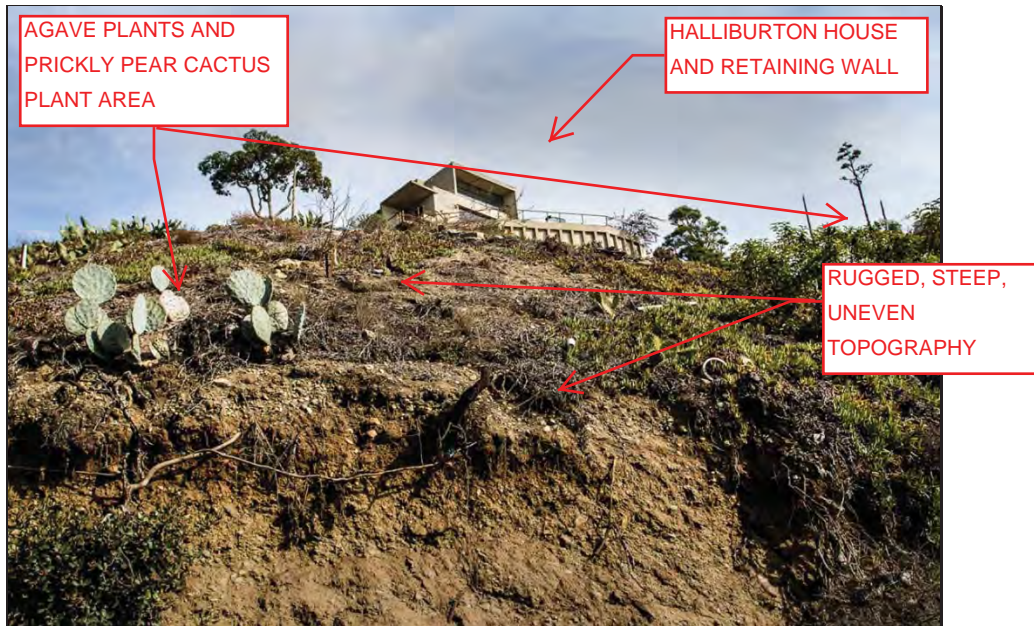

Topographic Characteristics, Vegetation Features, 31164 Ceanothus Drive

HALLIBURTON HOUSE INDIRECT IMPACTS ASSESSMENT

31172 Ceanothus Drive



Topographic Characteristics, Vegetation Features, 31152, 31162 Ceanothus Drive

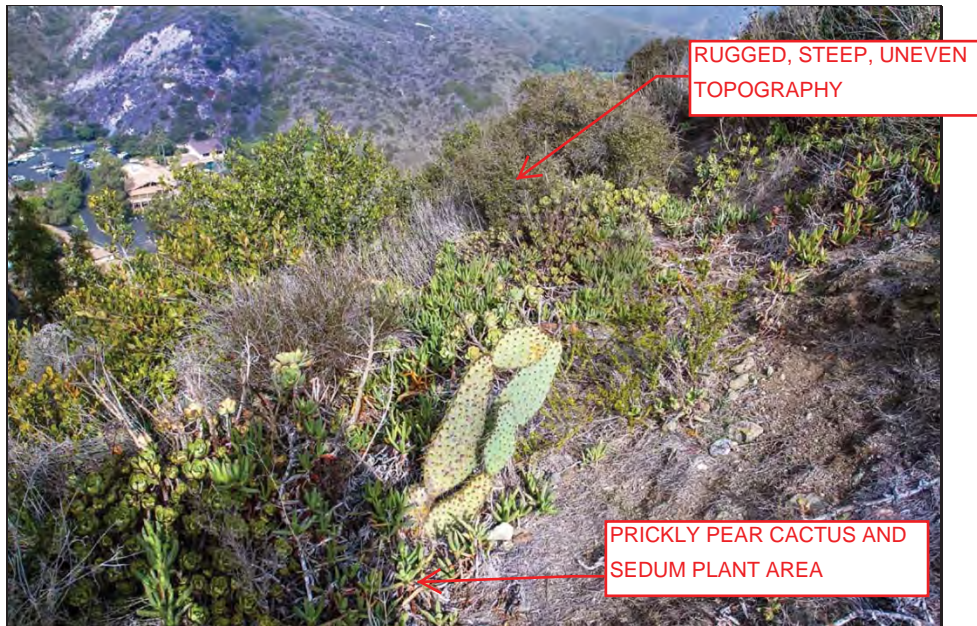

Topographic Characteristics, Vegetation Features, 31152 Ceanothus Drive

HALLIBURTON HOUSE INDIRECT IMPACTS ASSESSMENT

31172 Ceanothus Drive

FIGURE 3-10
VERNACULAR CULTURAL LANDSCAPE PHOTO INVENTORY



RUGGED,
UNEVEN AND
STEEP
TOPOGRAPHY

Topographic Characteristics, 31142 Ceanothus Drive



RUGGED, STEEP,
UNEVEN
TOPOGRAPHY
AND NATURAL
VEGETATION
(SEDUM,
CACTUS, ETC.)

Topographic Characteristics, Vegetation Features,
31142 Ceanothus Drive

HALLIBURTON HOUSE INDIRECT IMPACTS ASSESSMENT

31172 Ceanothus Drive

FIGURE 3-11

VERNACULAR CULTURAL LANDSCAPE PHOTO INVENTORY

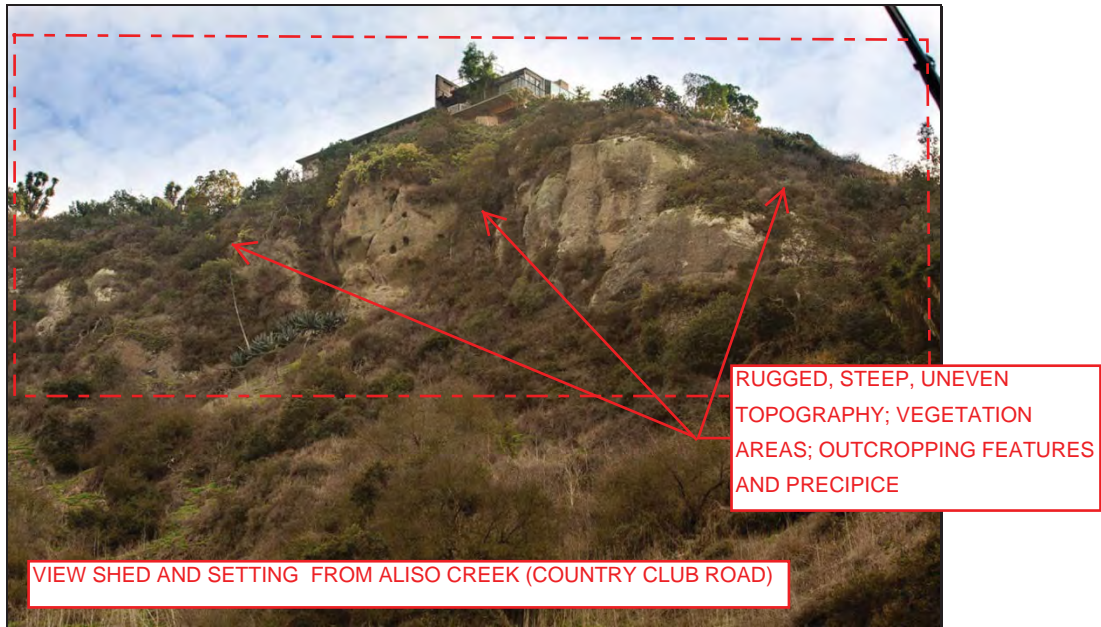

Topographic Characteristics, Vegetation and Outcropping Features, Views and Setting, 31142, 31152, 31174 Ceanothus Drive

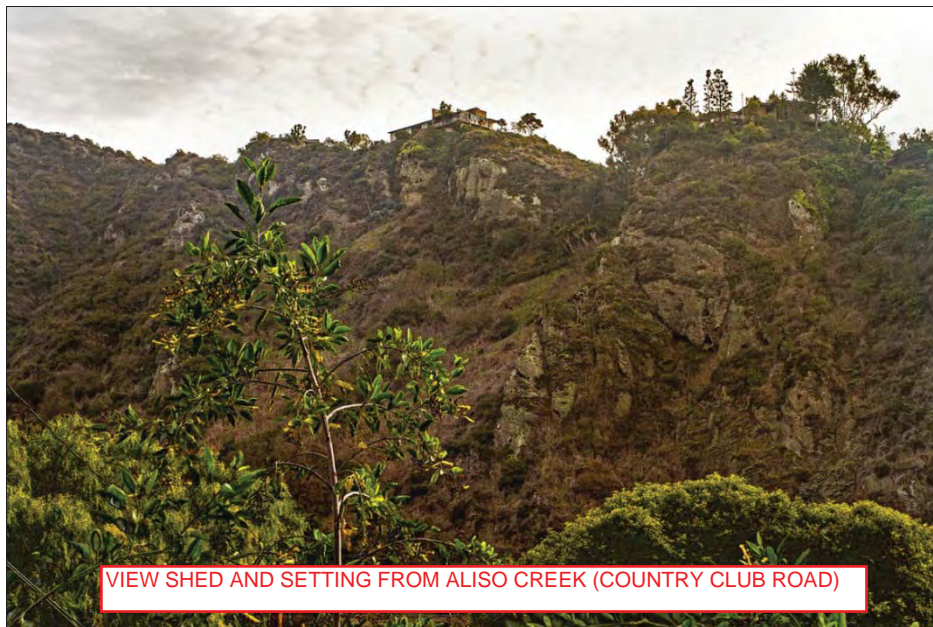

Topographic Characteristics, Vegetation and Outcropping Features, Views and Setting, 31142, 31152, 31174 Ceanothus Drive

HALLIBURTON HOUSE INDIRECT IMPACTS ASSESSMENT

31172 Ceanothus Drive

FIGURE 3-12
VERNACULAR CULTURAL LANDSCAPE PHOTO INVENTORY

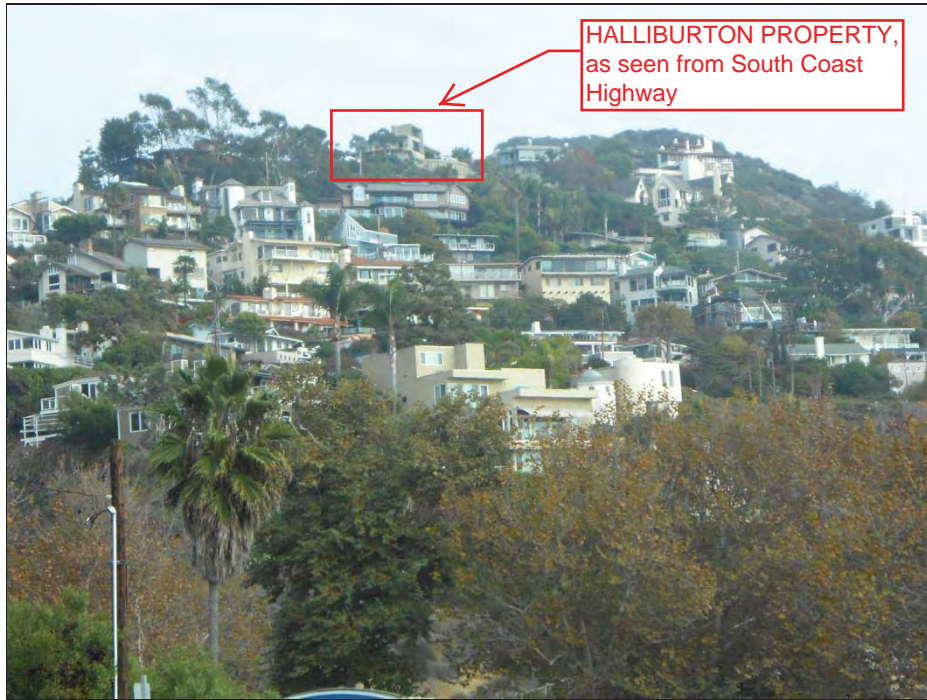

Views and Setting, 31142, 31152, 31162, 31164, 31180 Ceanothus Drive

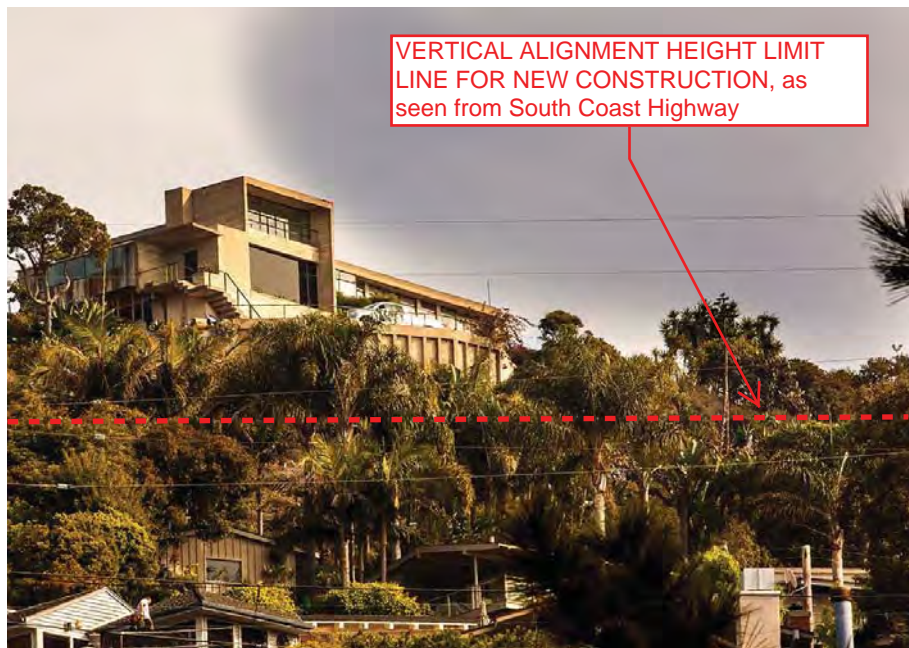

Views and Setting, 31152, 31162, 31164, 31180 Ceanothus Drive

HALLIBURTON HOUSE INDIRECT IMPACTS ASSESSMENT

31172 Ceanothus Drive



Vernacular Cultural Landscape Features, Agave Plants, Cactus, and Driveway,
31152, 31162, 31164 Ceanothus Drive



Vernacular Cultural Landscape Features, Agave Plants and Driveway,
31164 Ceanothus Drive

HALLIBURTON HOUSE INDIRECT IMPACTS ASSESSMENT

31172 Ceanothus Drive

FIGURE 3-14

VERNACULAR CULTURAL LANDSCAPE PHOTO INVENTORY

OSTASHAY & ASSOCIATES CONSULTING

PO BOX 542

LONG BEACH, CA 90801

562.500.9451

Halliburton House
(HANGOVER HOUSE)

Cultural Vernacular Landscape
Project Example

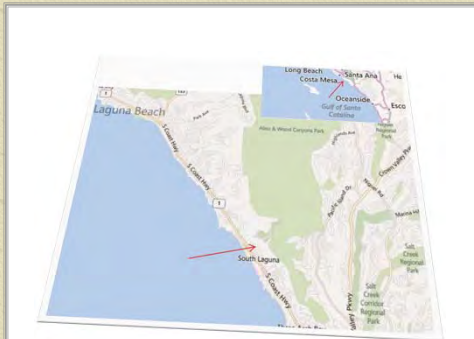

Project Location

Introduction



- ✘ Halliburton "Hangover" House, 1936-1937
- ✘ Potential Development Adjacent Halliburton House (HH)
- ✘ CEQA Nexus and Responsibilities
- ✘ Development Strategies and Outcome

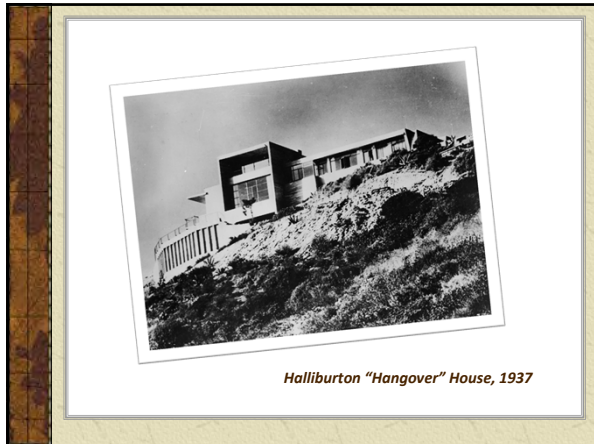

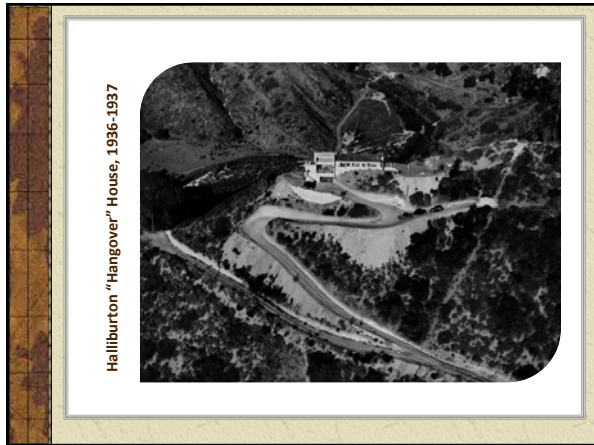

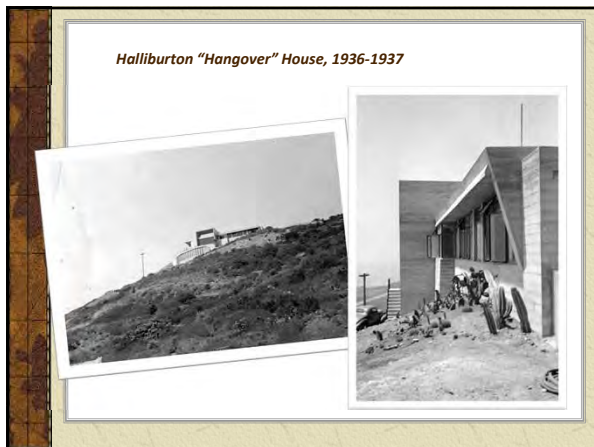

Project History



- ✘ HH previously identified as historic
- ✘ Subdivision of Halliburton property, 1982
- ✘ New property owners and potential development of subdivided vacant parcels
- ✘ Public concern regarding future development of vacant parcels and impacts to HH

Scope of Work

- ✘ Analyze potential future development of vacant parcels adjacent HH for CEQA compliance
- ✘ Identify any historic resources associated w/ HH
- ✘ Identify and assess potential indirect impacts to HH if development occurs on adjacent parcels
- ✘ Propose mitigation measures, if indirect adverse impacts are identified
- ✘ Prepare technical report to facilitate CEQA

Identification of Historic Resources

- ✘ Define Survey Study Area
- ✘ Identify properties within Survey Study Area
- ✘ Describe and evaluate properties for historical significance
- ✘ Identify character-defining features (site-specific CDFs)



Identification of Resources

Define Survey Study Area



Identification of Resources

Identify Properties within Survey Study Area



Identification of Resources

Character-defining Features of Site-Specific Resources:

- ✧ Character-defining Features (objective vs. subjective)

NPS "Preservation Brief #17: Architectural Character – Identifying the Visual Aspects of Historic Buildings as an Aid to Preserving Their Character"

NPS "Preservation Brief #36: Protecting Cultural Landscapes – Planning, Treatment and Management of Historic Landscapes"

Identification of Resources

Identify/Confirm Presence/Type of Cultural Landscape:

- ✦ Historic Designed Landscape
- ✦ Historic Vernacular Landscape
- ✦ Historic Site
- ✦ Ethnographic Landscape

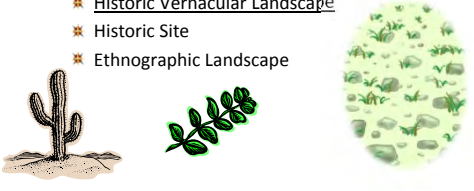

Identification of Resources

References Used to Identify Cultural Landscape/CDFs:

- ✦ Historic photographs and maps of site and area
- ✦ Historic aerial photographs of site and area
- ✦ References in various publications
- ✦ Field survey and plant assessment
- ✦ Newspaper articles and photographs
- ✦ Oral histories and other archival material



Identification of Resources

References Used to Identify Cultural Landscape CDFs:



Identification of Resources

References Used to Identify Cultural Landscape CDFs:



Identification of Resources

References Used to Identify Cultural Landscape CDFs:



Identification of Resources

CDFs of the Landscape (site-specific):

There are many character-defining features that collectively contribute to the historic character of a cultural landscape. These include:

- ✱ Topographic Characteristics ✓
- ✱ Circulation Features ✓
- ✱ Vegetation and Outcropping Features ✓
- ✱ Water Features
- ✱ Views and Setting ✓
- ✱ Structures, Site Furnishings, and Objects



Assessment of Potential Project Impacts

CEQA Thresholds of Significance/Criteria for Adverse Impacts
(CEQA Guidelines)

- ✦ Substantial adverse change in the significance of a historical resource means physical demolition, destruction, relocation, or alteration of the resource or its immediate surroundings such that the significance of a historical resource would be materially impaired.
- ✦ Demolishes or materially alters in an adverse manner those physical characteristics of a historic resource that convey its historical significance and justify its inclusion or eligibility in the California Register or a local register of historical resources.

Assessment of Potential Project Impacts

Substantial adverse effects may include, but are not limited to:

- ✦ Physical destruction or damage to all or part of a historic resource caused by vibration and/or sound; removal of the property from its historic location; isolation from or change of features within the property's historic setting; visual, atmospheric or audible intrusions; foreseeable effects that may occur later in time or farther removed in distance; and cumulative effects.

Assessment of Potential Project Impacts

- ❖ SOI Standards
- ❖ Reduce adverse impacts
- ❖ Class 31 Exemption (CEQA)



The Secretary of the Interior's Standards for the Treatment of Historic Properties with Guidelines for Preserving, Rehabilitating, Restoring & Reconstructing Historic Buildings

Guidelines for the Treatment of Cultural Landscapes

The Secretary of the Interior's Standards for the Treatment of Historic Properties provide a national framework for historic preservation. They are intended to guide the planning, design, and construction of historic properties and their surroundings. They are also intended to guide the planning and implementation of historic preservation projects.

Analysis of Potential Indirect Impacts

Project: Future Development of Adjacent Vacant Development Parcels

Consideration of Site-Specific Character-defining Features:

- ❖ Historic Topographic Characteristics
- ❖ Historic Circulation Features
- ❖ Historic Vegetation and Outcropping Features
- ❖ Historic Views and Setting

Finding:

- ❖ *Potentially Significant Impacts*

Analysis of Potential Indirect Impacts

Site-Specific CDFs and Potential Impacts:
31142 Ceanothus Drive



31142 Ceanothus Drive

Analysis of Potential Indirect Impacts

Site-Specific CDFs and Potential Impacts:
31152 Ceanothus Drive



Analysis of Potential Indirect Impacts

Site-Specific CDFs and Potential Impacts:
31162 Ceanothus Drive



Analysis of Potential Indirect Impacts

Site-Specific CDFs and Potential Impacts:
31164 Ceanothus Drive



Analysis of Potential Indirect Impacts

Site-Specific CDFs and Potential Impacts:
31174 Ceanothus Drive



An aerial photograph of a residential neighborhood with a specific site at 31174 Ceanothus Drive highlighted in red. The site is a rectangular lot with a house and some trees. Surrounding areas are also marked with red lines, indicating potential indirect impacts. The map includes street names and lot numbers.

Analysis of Potential Indirect Impacts

Site-Specific CDFs and Potential Impacts:
31180 Ceanothus Drive



An aerial photograph of a residential neighborhood with a specific site at 31180 Ceanothus Drive highlighted in red. The site is a rectangular lot with a house and some trees. Surrounding areas are also marked with red lines, indicating potential indirect impacts. The map includes street names and lot numbers.

Analysis of Potential Indirect Impacts

Site-Specific CDFs and Potential Impacts:
31204 Ceanothus Drive



An aerial photograph of a residential neighborhood with a specific site at 31204 Ceanothus Drive highlighted in red. The site is a rectangular lot with a house and some trees. Surrounding areas are also marked with red lines, indicating potential indirect impacts. The map includes street names and lot numbers.

Analysis of Potential Indirect Impacts

Site-Specific CDFs and Potential Impacts:
Halliburton House

- ✱ Historic Views and Setting



Analysis of Potential Indirect Impacts

Site-Specific CDFs and Potential Impacts:
Halliburton House

- ✱ Historic Views and Setting

Ultimate Findings:

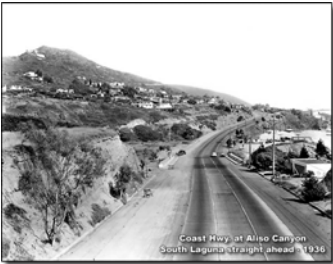

- ✱ *Potentially Significant Impacts*



CEQA Mitigation Approaches to Reduce Impacts

Consideration of Design Features and Mitigation Measures:

- ✱ Proposed to reduce or avoid potential adverse indirect impacts to Halliburton House and its surrounding historic environment (CDFs), which includes its overall SETTING, CONTEXT, and VERNACULAR CULTURAL LANDSCAPE FEATURES.



CEQA Mitigation Approaches to Reduce Impacts

Project Design Features (City Residential Design Guidelines):

- ✦ Design Articulation: site design; building mass, scale, and form; consideration of accessory structures and other features; garage design and placement.
- ✦ Environmental Context
- ✦ Historic Preservation – SOI Standards/Heritage Committee Review
- ✦ Landscape Considerations
- ✦ Neighborhood Compatibility
- ✦ View Equity



CEQA Mitigation Approaches to Reduce Impacts

Mitigation Measures:

- ✦ Verification and Approval of Project Entitlements
- ✦ SOI Standards Compliance – Review and Approval
- ✦ Site-specific Compatibility Guidelines and City Review
- ✦ Historic Landscape Design Plan/Process
- ✦ Historic Landscape Maintenance Plan
- ✦ Vibration Survey Assessment and On-site Monitoring



Findings and Conclusions

Level of Significance After Mitigation:

- ✦ **LESS THAN SIGNIFICANT**



Project Implementation/Current Status:

- ✦ Proposed Projects: Process, Design, Approval, and Implementation

